



PRODUCT TECHNICAL SHEET

Aura SPA thub
2,28 x 2,28 m x 0,94 m

All rights reserved

Structure of the bathtub

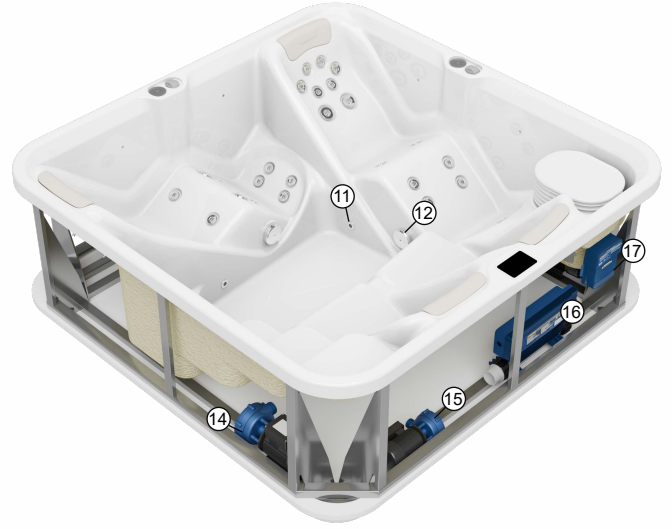
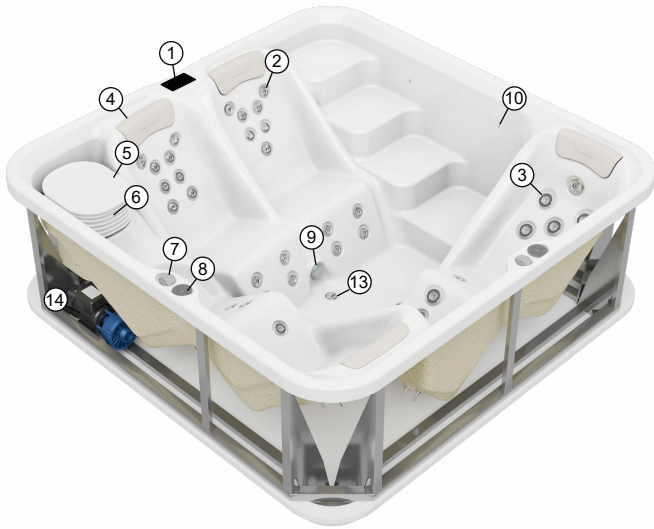

Features

- | | |
|--------------------|---|
| 1. Display | 10. LED lighting |
| 2. 2" nozzle | 11. Inlet nozzle |
| 3. 3" nozzle | 12. 5" suction |
| 4. Cushion | 13. Drain |
| 5. Skimmer housing | 14. Massage pump |
| 6. Filter | 15. Circulation pump |
| 7. Air valve | 16. Gecko IN.YE-3 controller with 3 kW heater |
| 8. Speaker | 17. Gecko IN.STREAM 2 Bluetooth module |
| 9. LED lamp | 18. * |

Additionally, there is an option to install an automatic chemical dosing station at the customer's request.

Massage zone layout

